

## KNX Modern Series DLP Smart Panel EU(US)

M/DLP04.1

Product Version: A2



Datasheet

Version: V1.0

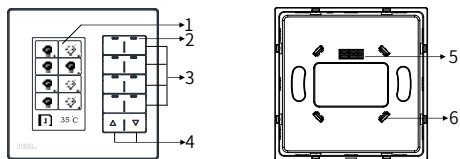

KNX Modern Series DLP Smart Panel EU  
Figure 1.

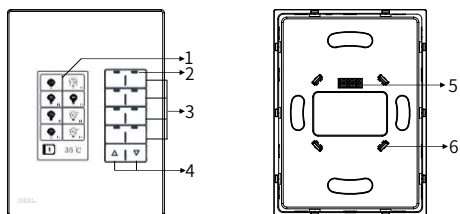

KNX Modern Series DLP Smart Panel US  
Figure 2.

NO.	Description
1	LCD screen
2	Button indicator
3	Control button
4	Page button
5	KNX communication interface
6	Mounting hook

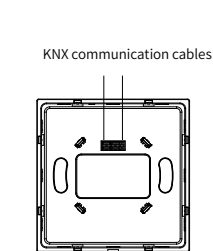

KNX Modern Series DLP Smart Panel EU  
Figure 3. Wiring

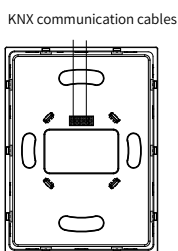

KNX Modern Series DLP Smart Panel US  
Figure 4. Wiring

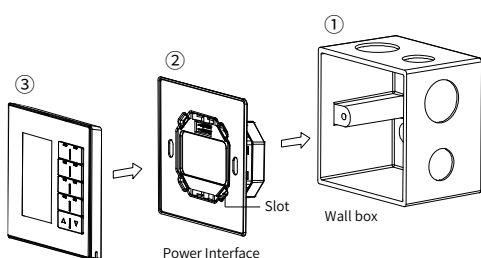

Figure 5. Installation

## Overview

**KNX Modern Series DLP Smart Panel EU(US)** (see Figure 1 & 2, hereinafter referred to as the “product” or “device”) is a multi-function control panel specially designed for home automation.

Note: The pictures in this datasheet are for reference only and the actual product should prevail.

Please read the datasheet carefully before use.

### Key Functions:

- KNX communication protocol
- Online setting and configuration via Engineering Tool Software (ETS)
- LCD screen: It is with the resolution of 160 x 80 pixels, which is compatible for time and temperature display. Plus, icons for page 1, 2, 3 can be customized via “HDL KNX Assistant Software” .
- Control pages: 3 switch control pages, 1 floor heating page and 1 air conditioner page.
- 8 control buttons: Available for users to control target devices; Each control button is equipped with a dot-matrix LCD display.
- 2 page buttons: Available for users to select different pages
- Button indicators: Available for indicating the status of control targets, with adjustable backlight brightness
- Types for control targets: switches, dimming devices, curtains, scenes, flexible control, sequence control, per centage control, threshold control, alternate control, string (14bytes) control, combination control, HVAC control, floor heating control, button lock, button trigger, temperature report and night mode setting.

## Appearance

See Figure 1 & 2.



## Safety Precautions

- The installation and testing for the product must be carried out by HDL Automation Co., Ltd. (hereinafter referred to as HDL) or its appointed service agencies. The electric construction shall comply with local laws and safety regulations.
- HDL will not be responsible for any consequence caused by the inexpert or faulty installation and wiring methods, which are not in accordance with the instructions contained in this datasheet.
- Please do not privately disassemble or replace any parts of the product. Otherwise, it may cause mechanical fault, electric shock, fire or personal injuries.
- Please contact HDL after-sales departments or our designated service agencies for your maintenance service. Product failures caused by private disassembly are not subject to the warranty.
- Prior to performing installation, disassembly or maintenance on the device, disconnect the device from all voltage sources, so as to avoid electric leakage and electric shock.
- Do not use corrosive liquid to wipe the device body, especially the interface, so as to avoid damage to the device.
- Do not wipe the device with damp cloth.
- It is a MUST to install the device with wall box.
- It is a MUST to make the device be in conjunction with the specific power interface, as described below:
  - KNX Modern Series DLP Smart Panel EU should be connected with KNX Panel Power Interface EU (Model: M/PCI.1-A)
  - KNX Modern Series DLP Smart Panel US should be connected with KNX Panel Power Interface US (Model: M/PCI.3-A)

## Wiring

See Figure 3 & 4.

⚠ Note: After all of the cables are terminated, check for correct and good terminations.

### KNX Cable Guide

KNX	KNX Cable
+	Red
-	Black

## Installation

📖 Tips: It is a MUST to make the device be in conjunction with power interface. Before installation, please prepare proper power interface and screws.

⚠ Warning: Prior to performing installation on the device, disconnect the device from all voltage sources.

**For installation, please see Figure 5 and the following instructions.** Here it takes **KNX Modern Series DLP Smart Panel EU** as an example.

- Step 1. Place the wall box into the proper wall body.
- Step 2. Fix the power interface into the wall box with screws.
- Step 3. Align the mounting hook with the slot, then assemble the panel onto the power interface.

⚠ Note: Before installation, please get the necessary cables ready in the wall box. Before powering on, please ensure the device is tightly onto the wall body.

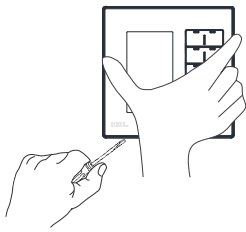

Figure 6. Disassembly

## Disassembly

**Warning:** Prior to performing disassembly on the device, disconnect the device from all voltage sources

For disassembly, please see **Figure 6** and the following instructions.

Here it takes KNX Modern Series DLP Smart Panel EU as an example.

Step 1. It is recommended to place a screwdriver between the gap of the panel and power interface, then loosen the panel.

Step 2. To remove the panel and power interface, please refer to the reverse steps in the section *Installation*.

## Operation

For operation, please see **Figure 7 & 8** and the following instructions.

Item	Operation	Device Status
<b>Programming mode</b>	Simultaneously press Button <b>A1</b> & <b>A10</b> for 2s.	The corresponding button indicators flash, which means that the device enters programming mode.
<b>Panel lock or unlock</b>	Simultaneously press Button <b>A2</b> & <b>A9</b> for 2s.	Panel is locked or unlocked.
<b>Menu</b>	<p>Step ① Simultaneously press Button <b>A9</b> &amp; <b>A10</b> for 2s.</p> <p>Step ② Select the item needed and proceed resetting, as described below.</p>	<p>① The device enters menu page.</p> <p>② Resetting results vary from function to function , as described below.</p>
	<b>C/F:</b> Conversion between Celsius and Fahrenheit temperature.	
	<b>Page:</b> Select the page to be locked when turning on Lock mode.	
	<p><b>AtDk:</b> 1T/2T, the backlight will darken after no operation for delay time, and when operate the panel again.</p> <ul style="list-style-type: none"> <li>• 1T: Control target and brighten backlight immediately.</li> <li>• 2T: The first operation is to brighten backlight, second operation is to control object.</li> </ul>	
	<p><b>Lock:</b> Turn on or off password lock mode.</p> <p>This function locks the menu page and the page selected by the Page option, when there is no operation for 30s. In this case, enter password to unlock.</p>	
	<p><b>Password:</b> Set the password.</p> <p>The factory password and a new password should be entered. If it is initial use of the device, enter the factory password “8552” .</p>	

## Technical Data

Working voltage	21 - 30V DC	Working current	20mA/30V DC
Communication protocol	KNX	Cable diameter of KNX terminal	0.6 - 0.8mm
Working temperature	-5°C~45°C	Storage temperature	-20°C~60°C
Working relative humidity	≤90%, non-condensed	Storage relative humidity	≤93%

## Specifications

Dimensions (W × H × D)	EU: 86×86×10.5(mm) (See Figure 9) US: 116.5×86×10.5(mm) (See Figure 10)	Net weight	EU: 109g US: 131g
LCD screen resolution	160×80pixels	Housing material	Glass, PC, ABS, Aluminum
Installation	Wall-mounted (See Figure 5)	Approved	CE, RoHS, KNX
Protection rating (Compliant with EN 60529)	IP20		

## Packing List

KNX Modern Series DLP Smart Panel EU (or US) \*1 / Datasheet\*1

KNX Modern Series DLP Smart Panel EU  
Figure 7. Operation

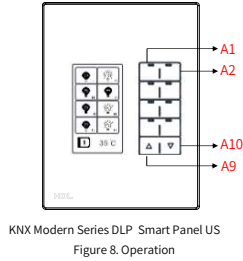

KNX Modern Series DLP Smart Panel US  
Figure 8. Operation

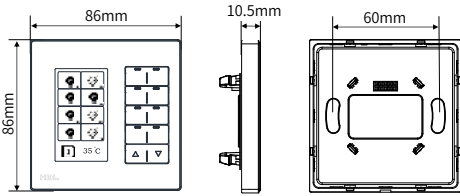
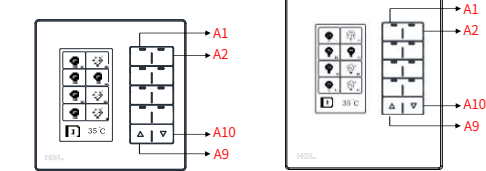

KNX Modern Series DLP Smart Panel EU  
Figure 9. Dimensions

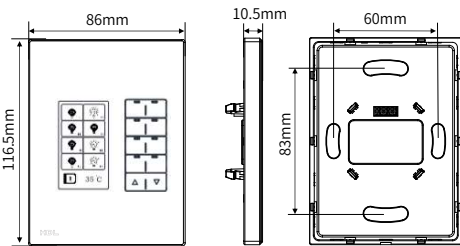

KNX Modern Series DLP Smart Panel US  
Figure 10. Dimensions

### Technical support

E-mail: [hdtickets@hdlautomation.com](mailto:hdtickets@hdlautomation.com)

Website: <https://www.hdlautomation.com>

HDL has all the intellectual property rights to this document and contents thereof. Reproduction or distribution for third parties are prohibited without written authorization from HDL. Any infringement of HDL's intellectual property rights will be investigated the legal liability.

The contents of this document will be updated as the updates of product versions or other reasons. Unless otherwise agreed upon, this document is to be used as a guidance only. All the statements, information and recommendations in this document makes no warranty expressed or implied.

© 2023 HDL Automation Co., Ltd. All rights reserved.