

M/PTCL1  
KNX Tile Series Power Interface

Hardware Version: A

Notes: The power interface works with Tile series panels, both plastic and metal versions and both horizontal and vertical installations.



**Datasheet**

Issued: June 26, 2019

Edition: V1.0.0



Figure 1. KNX Tile Series Power Interface

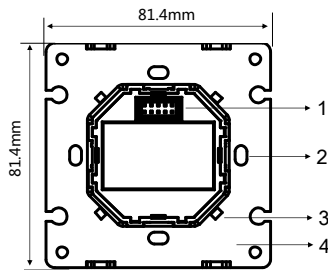

Figure 2. Dimensions - Front View

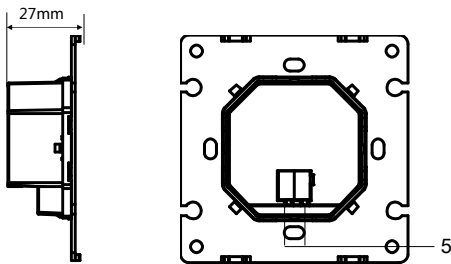

Figure 3. Dimensions - Side View

Figure 4. Components - Back View

## Overview

KNX Tile Series Power Interface (See Figure 1-2) works in conjunction with KNX Tile Series panels and provides working voltage and communication signals to the panel.

## Functions

- Provides working voltage to panel.
- Provides communication signals to panel.

## Important Notes

- The panel power interface should be installed on the wall box.
- The power interface should work in conjunction with panel.
- Bus cable - KNX standard cable.

## Product Information

**Dimensions - See Figure 2 - 3**

1. **Communication interface:** Provides working voltage and signals.
2. **Screw hole:** Used to secure the power interface into the wall box.
3. **Mounting slot**
4. **Metal plate**
5. **KNX bus connector**

**Components - See Figure 4**

**Product installation and disassembly**

**Installation - See Figure 5**

- Step 1. Install the wall box in the wall.
- Step 2. Secure the power interface onto the wall box with screws.
- Step 3. Install the panel on the power interface.
- Step 4. Install the frame around the panel.

## Safety Precautions

- The installation and commissioning of the device must be carried out by HDL or the organization designated by HDL. For planning and construction of electric installations, the relevant guidelines, regulations and standards of the respective country are to be considered.
- The device should be wall box mounted. HDL does not take responsibility for all the consequences caused by installation and wire connection that are not in accordance with this document.
- Please do not privately disassemble the device or change components, otherwise it may cause mechanical failure, electric shock, fire or body injury.
- Please resort to our customer service department or designated agencies for maintenance service. The warranty is not applicable for the product fault caused by private disassembly.

## Package Contents

M/PTCL1\*1 / Datasheet\*1 / Long screw\*2 / Short screw\*2

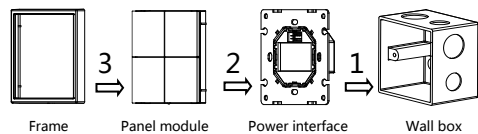

Figure 5. Installation

## Technical Data

### Basic Parameters

|                                |           |
|--------------------------------|-----------|
| Working voltage                | 21~30V DC |
| Communication                  | KNX       |
| Cable diameter of KNX terminal | 0.6-0.8mm |

### External Environment

|                           |            |
|---------------------------|------------|
| Working temperature       | -5°C~45°C  |
| Working relative humidity | ≤90%       |
| Storage temperature       | -20°C~60°C |
| Storage relative humidity | ≤93%       |

### Specifications

|   |                              |
|---|------------------------------|
| Dimensions                                  | 81.4×81.4×27 (mm)            |
| Net weight                                  | 69g                          |
| Housing material                            | Flame-retardant nylon, metal |
| Installation                                | Wall box (See Figure 5)      |
| Protection rating (Compliant with EN 60529) | IP20                         |

### Name and Content of Hazardous Substances in Products

| Components | Hazardous substances |              |              |                       |                                 |  |
|------------|----------------------|--------------|--------------|-----------------------|---------------------------------|--|
|            | Lead (Pb)            | Mercury (Hg) | Cadmium (Cd) | Chromium VI (Cr (VI)) | Poly-brominated biphenyls (PBB) | Poly-brominated diphenyl ethers (PBDE) |
| Plastic    | o                    | o            | o            | o                     | o                               | o                                      |
| Hardware   | o                    | o            | o            | o                     | -                               | -                                      |
| Screw      | o                    | o            | o            | ×                     | -                               | -                                      |
| Solder     | ×                    | o            | o            | o                     | -                               | -                                      |
| PCB        | ×                    | o            | o            | o                     | o                               | o                                      |
| IC         | o                    | o            | o            | o                     | ×                               | ×                                      |

The symbol "-" indicates that the hazardous substance is not contained.

The symbol "o" indicates that the content of the hazardous substances in all the homogeneous materials of the component is below the limit requirement specified in the Standard IEC62321-2015.

The symbol "x" indicates that the content of the hazardous substance in at least one of the homogeneous materials of the part exceeds the limit requirement specified in the Standard IEC62321-2015.

## KNX Cable Guide

| KNX | KNX Cable |
|-----|-----------|
| -   | Black     |
| +   | Red       |

#### Technical support

E-mail: support@hdlautomation.com

Website: <https://www.hdlautomation.com>

©Copyright by HDL Automation Co., Ltd. All rights reserved.  
Specifications subject to change without notice.